

KIT: A33-102S

10" Wide Aluminum Flat Truss. 2" Chords with 1/2" Webs

©2017 EXHIBIT AND DISPLAY TRUSS.COM

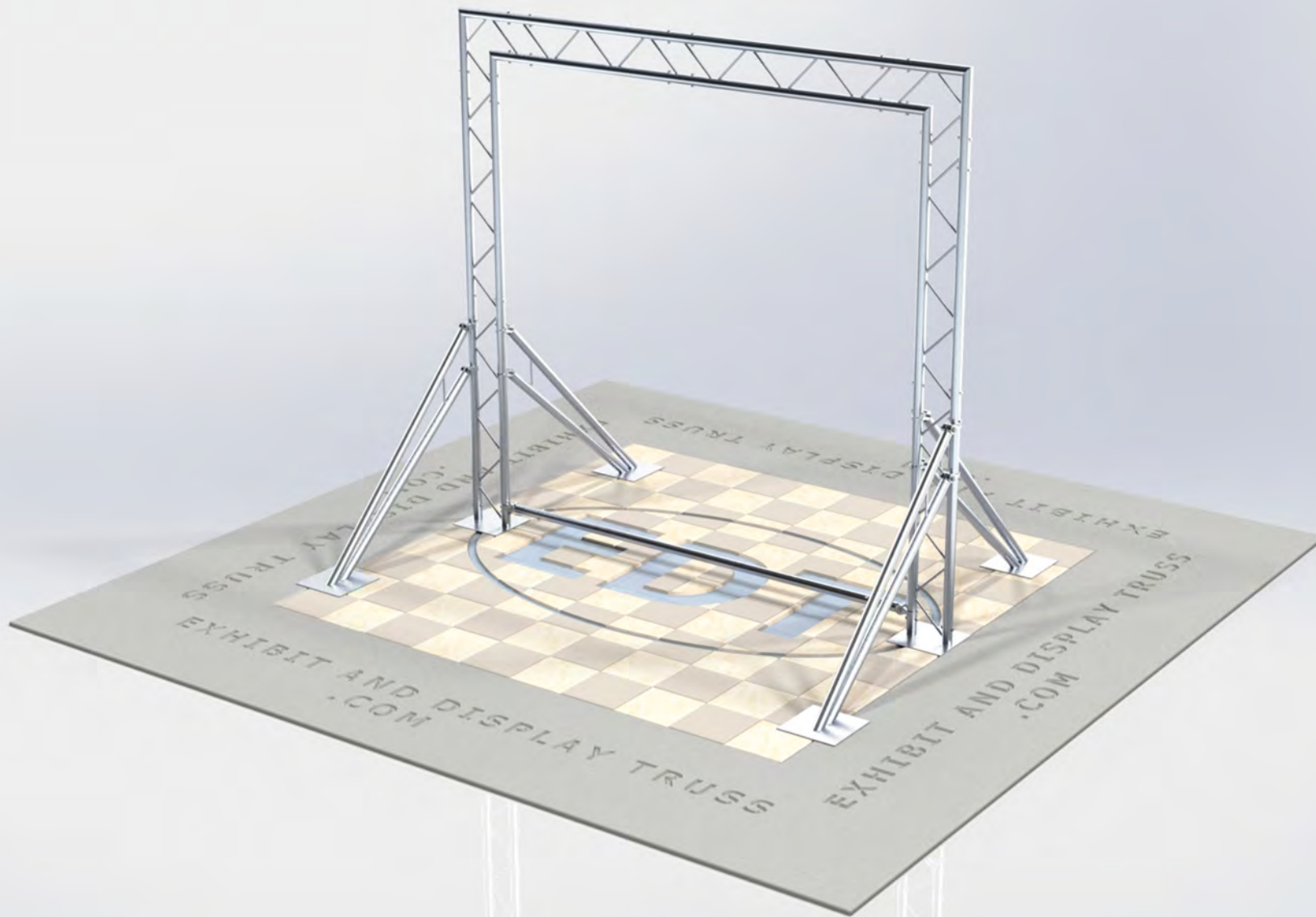

Toll Free: 855-323-4866
Email: info@exhibitanddisplaytruss.com

ExhibitAndDisplayTruss.com

KIT: A33-102S

10" Wide Aluminum Flat Truss. 2" Chords with 1/2" Webs

©2017 EXHIBIT AND DISPLAY TRUSS.COM

©2017 EXHIBIT AND DISPLAY TRUSS.COM

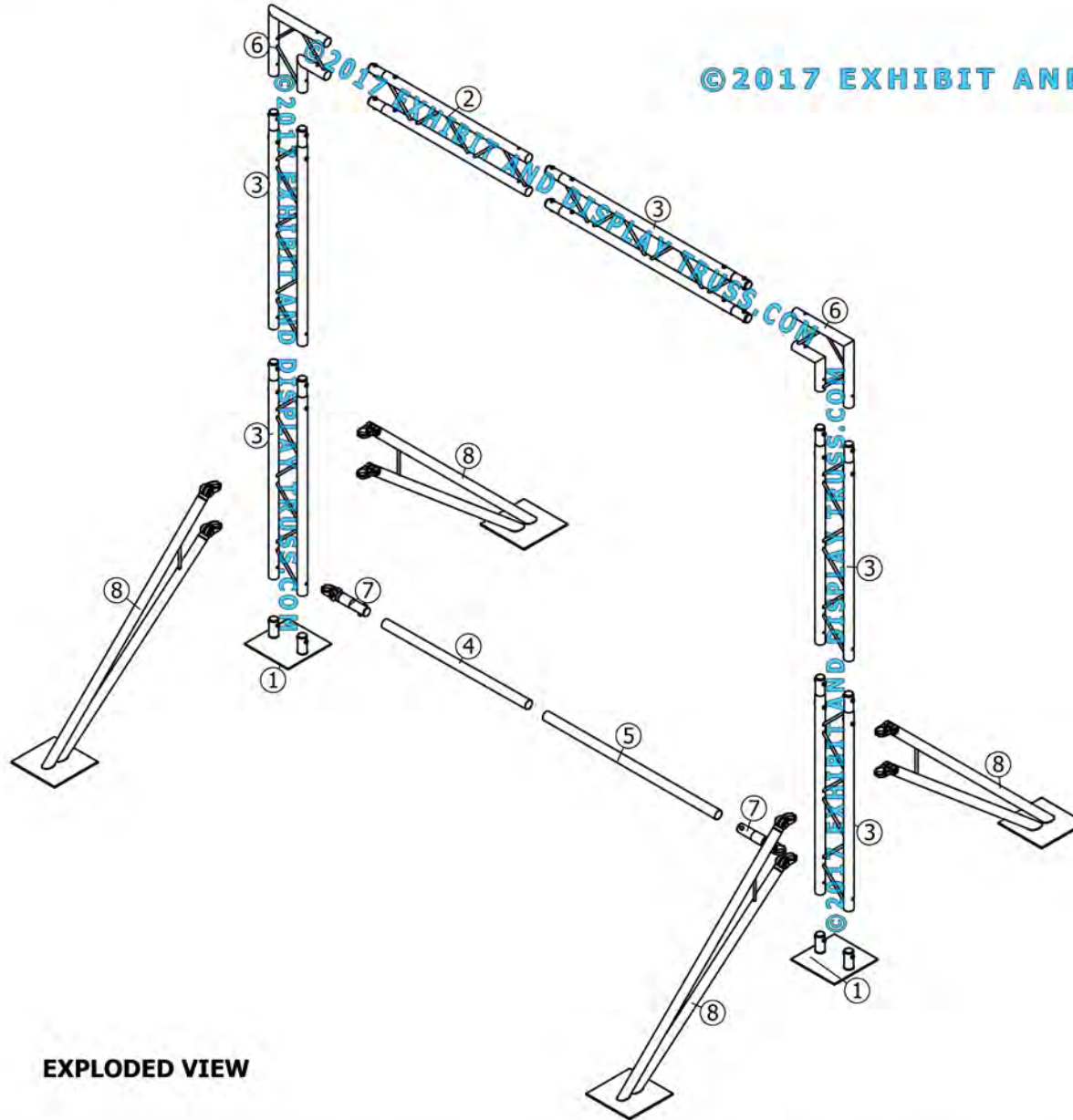
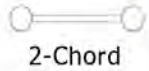

EXPLODED VIEW

ITEM NO.	PART NUMBER	DESCRIPTION	QTY.
1	EDT10-BP2-12x12	Ladder Base Plate (12"x12")	2
2	EDT10-L1.0	1.0m Ladder Truss	1
3	EDT10-L1.2	1.2m Ladder Truss	5
4	EDT2-ST1.0	1.0m Single Tube	1
5	EDT2-ST1.2	1.2m Single Tube	1
6	EDT10-L2W90H	2 Way 90° Junction Horizontal	2
7	EDT10-EHC1	Extender Hook Clamp	2
8	EDT2-OR1	Outrigger Arms with Swivel Hooks	4

KIT: A33-102S

10" Wide Aluminum Flat Truss. 2" Chords with 1/2" Webs

©2017 EXHIBIT AND DISPLAY TRUSS.COM

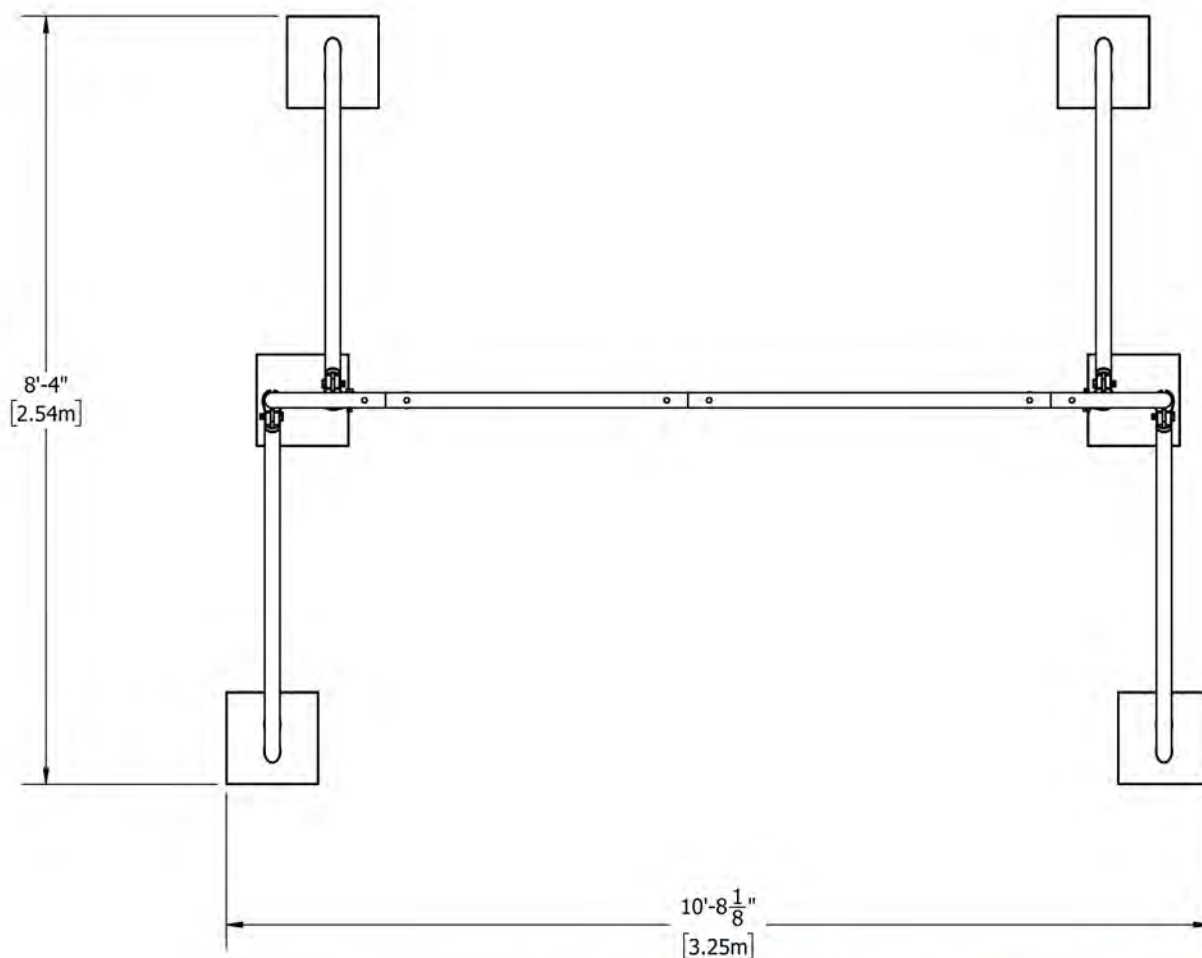
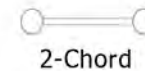

©2017 EXHIBIT AND DISPLAY TRUSS.COM

KIT: A33-102S

10" Wide Aluminum Flat Truss. 2" Chords with 1/2" Webs

©2017 EXHIBIT AND DISPLAY TRUSS.COM

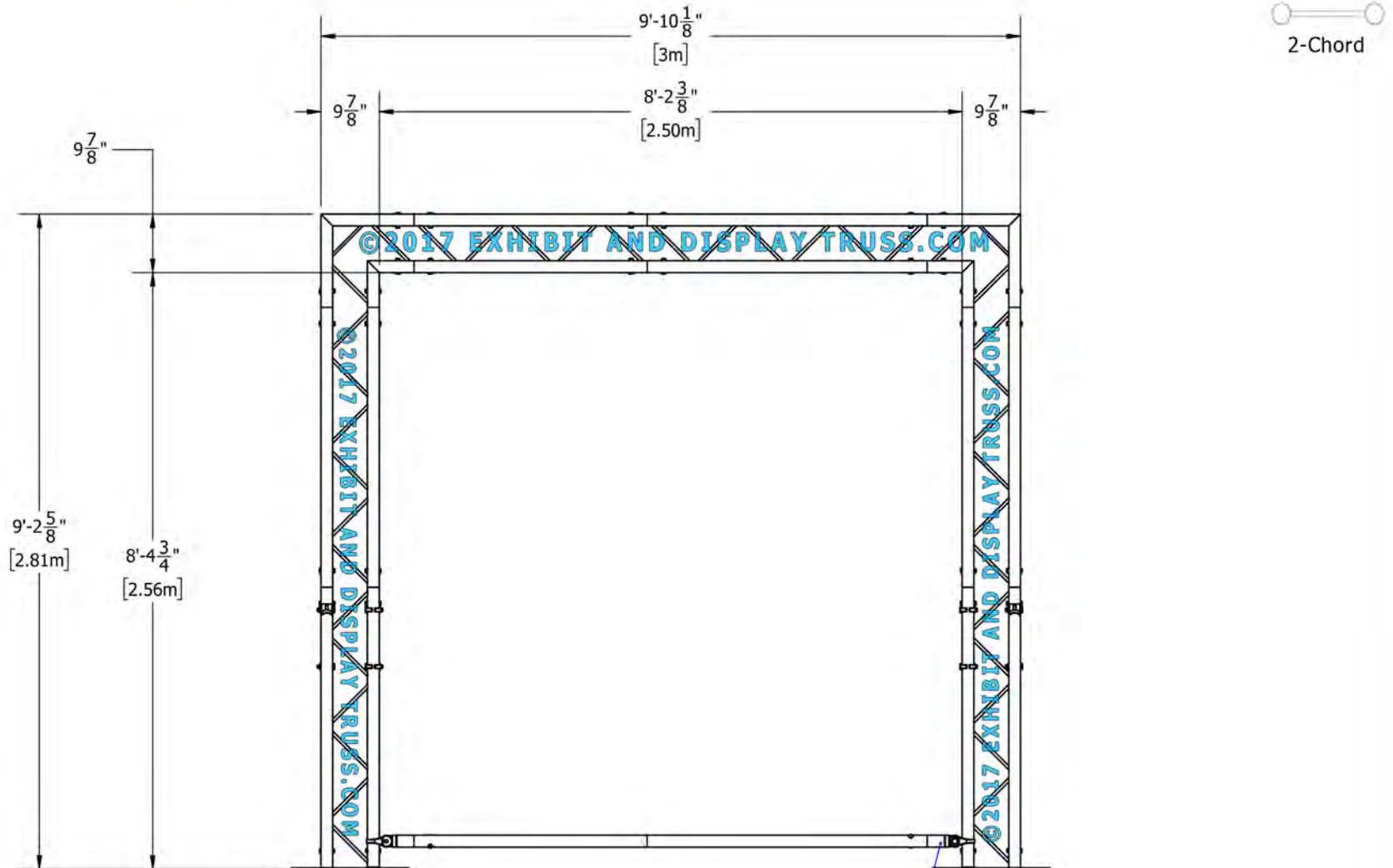

Front View
Units: Feet & Inches
[Meters]

Extender hooks clamps allow single tube to be moved vertically to desired position.

©2017 EXHIBIT AND DISPLAY TRUSS.COM